

TILLAMOOK COUNTY SURVEYORS OFFICE  
 COURT HOUSE, TILLAMOOK OREGON 97141

SECTION CORNER COMMON SECTIONS 5 & 6 T.2N., R.9W., W.M.  
 AND SECTIONS 31 & 32 T.3N., R.9W., W.M.

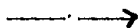

RM #1  
 RS 287  
 1975

I found a 2" iron pipe with a 3" Tillamook County Surveyors Brass cap, Reference Mark #1, (see T.C.S. Rewitness Bin Card #66), in the center of the East bound lane of Batterson County Road, N.89°49'W. 59.39'; (Found, at position, I set an 8" diameter cast iron monument case around the found iron pipe and brass cap, and encased in concrete).

-----  
 History of Found Monument

I found this monument to be as described on T. C. S. Rewitness card #66, and the references found and/or set at that time to now be as follows:

RM #2  
 RS 287  
 1975

I found a 2" iron pipe with a 3" Tillamook County Surveyors Brass Cap, Reference Mark #2, (See T.C.S. Rewitness Card #66), S.89°49'E. 48.80' from the Section Corner; (Found, at position).

\* (Book 4 Page 82) 8" hemlock S.42°E. 27.8', Reported on Rewitness Card #66 as a 12"; (Found, now a 26" Hemlock with a healed face. Bearing and dist. from corner not checked, corner monument missing).

\* (Book 4 Page 82) 6" hemlock N.40°E. 29.7', Reported on Rewitness Card #66 as a 12"; (Found, now a 27" hemlock with a healed face. Bearing and dist. from corner not checked, corner monument missing).

\* (Book 4 Page 82) 18" hemlock N.40°W. 37.2', Reported on Rewitness Card #66 as a 24"; (Now gone).

(Original) 10" hemlock S.71°E. 71 lks. Reported on Rewitness Card #66 as a 40" snag 12' high old face on bark not exposed; (Found, now a 40" decayed snag 10' high).

\* (Rewitness Card #66) 86" hat section post West 12.5' of RM #1; (Found, okay).

\* (Rewitness Card #66) 86" hat section post East 1.5' of RM #2; (Found, okay).

\* indicates Tillamook County Surveyors yellow metal location poster attached.

-----  
 References not listed on Rewitness Card #66

A-2733	Nov.-1974 / June-1976	John L Carlich	RS 287
B-1224	July-1986	Anthony Klosterman	LS 1998
Rewitness Card #66	1967 / 1970 / 10-22-75	John L Carlich	RS 287

-----  
 Location of Corner

This corner is located on a steep back slope on Batterson County Road. The corner monument is now missing and is located in an unstable area, use RMS for position.

-----  
 IN THE PRESENCE OF:  
 DAN MCNUTT & AL DVORAK

JUNE, 3 1992

TITLE

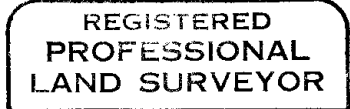
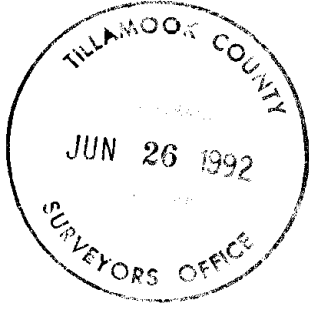

*Allan E Duncan C.S.*

